

# SOUND BALANCE ACOUSTIC WALL

## Product data sheet



work inspired

### Product description

Effective acoustic wall to optimize the room acoustics in open-plan offices. The inner core is made of thermal compressed polyester fibre; the product has a concealed aluminium frame, is covered with high-quality fabric and comes with a pre-mounted base plate made of matt anodised aluminium, along with flat aluminium feet to mount separately.

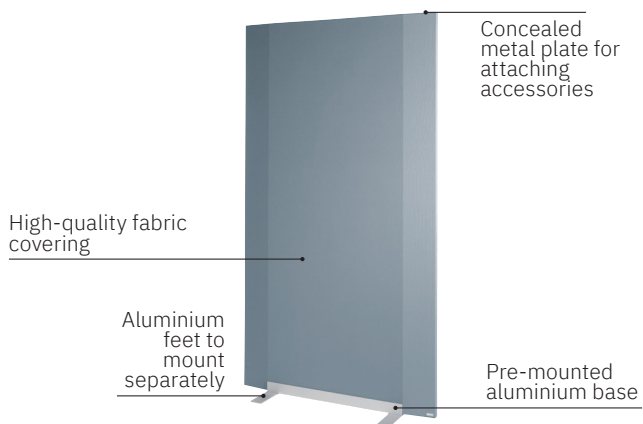

### Formats and weights

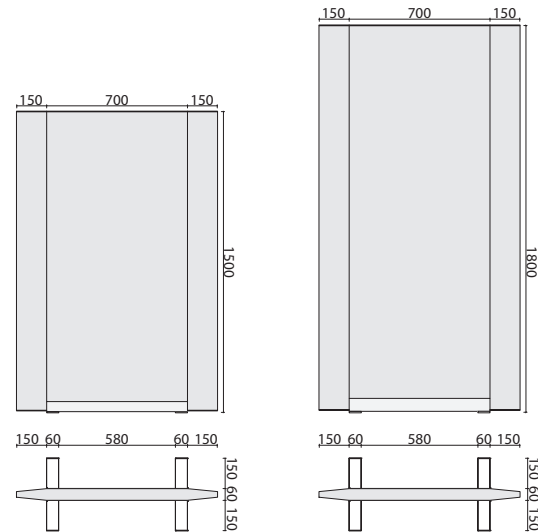

SB500 / SB501  
W x h x d: 1000 x 1500 x 60 mm  
Weight: 16740 g

SB510 / SB511  
W x h x d: 1000 x 1800 x 60 mm  
Weight: 19120 g

### Sound absorption material

- Thermal compressed polyester fibre
- Ideal acoustic properties (specific flow resistance  $R_s = 1240 \text{ Pa s/m}$ )
- Pollutant-free as defined by the REACH regulation

### Fabric quality & colours

- High-quality, synthetic polyester fibres
- Robust, abrasion-resistant and easy to clean
- Clean with a wet or dry cloth
- Pollutant-free as defined by the REACH regulation
- In 2 muted colours for modern interior design

### Acoustic performance

The acoustic walls comply with sound absorption class B (rated sound absorption coefficient  $\alpha_w$  according to DIN EN ISO 11654 = 0.85). The acoustic performance has been tested and certified by Müller-BBM, an independent institute for acoustics.

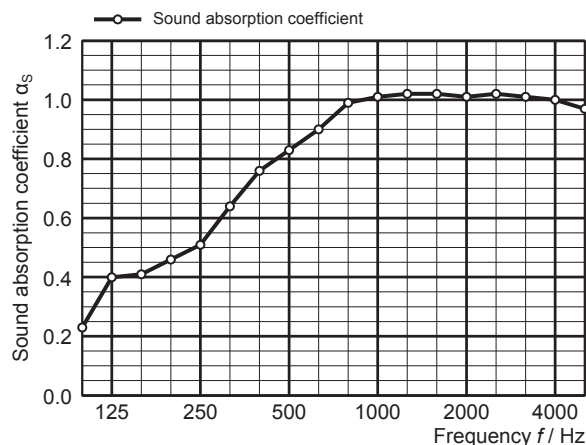
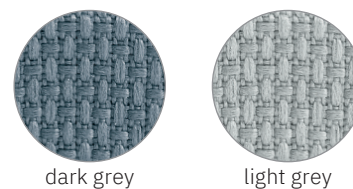

Rating according to ISO 11654: Weighted sound absorption coefficient $\alpha_w = 0.85$ (H) Sound absorption class: B	Rating according to ASTM C423: Noise Reduction Coefficient $NRC = 0.85$ Sound Absorption Average $SAA = 0.85$
---	---

### Product safety

- GS-approved product safety certified by TÜEV Sued Product Service GmbH
- TÜEV-approved product properties according to DIN EN 1023-1:1996, DIN EN 1023-2:2001, DIN EN 1023-3:2001
- High-quality, low-polluting materials, high stability



# SOUND BALANCE ACOUSTIC WALL

## Product data sheet

### Mounting

The acoustic wall comes with a pre-mounted aluminium base; the two aluminium feet have to be mounted separately before the wall is positioned in the room. To do so, simply screw the two feet onto the base using the enclosed mounting set. The wall is then stable and can be placed wherever required. The feet also come with pre-mounted anti-slip pads that ensure a secure stand and protect the floor from scratches.

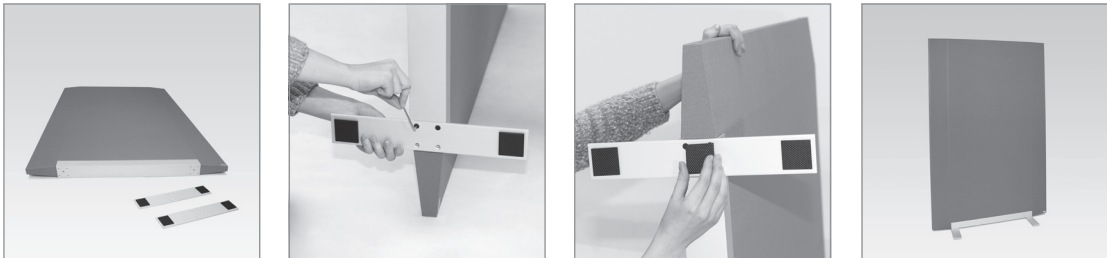

### Product quality

All products in the Sound Balance range are of high quality and manufactured without visible seams. We pay the greatest attention to every detail of the manufacturing process. This means the Sound Balance products meet the highest standards of modern interior design and fulfil the SIGEL promise of top brand quality.

### Fire safety

The acoustic walls are classified as normal flammable materials according to DIN 4102-1 (classification B2). Fire behaviour according to DIN EN 13501-1 is certified as Class E (normal flammable materials).

### Multifunctionality

The surface of the acoustic walls is easy to use for exchanging ideas and collaborative work. To this end, SIGEL provides an intelligently designed accessories range, developed especially for Sound Balance, consisting of flipchart hooks (prod. code SB700), a writing panel (prod. code SB710) and storage box (prod. code SB720). These accessories are easy to attach to the acoustic walls by means of their integrated magnet. In addition to this, the surface of all Sound Balance acoustic products can be used as a pinboard.

We recommend using the Sound Balance accessories in combination with SIGEL brand writing and cleaning products, e.g. whiteboard markers (prod. code (MU180/181), cleaning spray or cloth (prod. code MU200, MU202) and pins (prod. code MU190).



SB700 Flipchart hooks



SB720 Storage box



SB710 Writing panel

Subject to changes and variations.